

# Reliable. Secure. Future-Proof.

easee®



# Charge Pro



As a Charge Point Operator, uptime, security and scalable smart infrastructure are vital to operational success. The Easee Charge Pro is engineered specifically for commercial environments where performance, remote management, and cost-efficiency are key. Whether you're managing a few chargers or scaling a large network, the Easee Charge Pro provides a reliable, future-ready platform that reduces site visits and maximizes ROI.

## This helps you to

- Achieve unparalleled network control and operational efficiency.
- Develop advanced, value-added services with rich data and certified accuracy.
- Build a trusted, future-ready network on a foundation of proven reliability.

## The Easee advantage

Our philosophy of *Effortless Electrification* is built on a respect for open standards and collaboration. We believe hardware should be an enabler, not a limitation. The Easee Charge Pro is the embodiment of this belief, thoughtfully designed to integrate seamlessly with your software and support your long-term success.

### Simplified, reliable connectivity

Our built-in eSIM ensures chargers are always connected with no complex SIM card management required. For maximum resilience, our Direct OCPP capability allows chargers to connect straight to your backend, providing operational continuity and ensuring chargers on your platform remain online and under your control.

#### How we deliver

Always-on connectivity via a built-in eSIM, ensuring each charger is online and reachable when powered, independent of its OCPP connection status. Complemented by flexible integration paths, including OCPP 1.6J and APIs

#### This means for your platform

A resilient and trustworthy network that minimizes offline events and eliminates the operational hassle of managing physical SIM cards.

### Count on verified security

Protect your business, your data, and your users with hardware engineered for security. The Easee Charge Pro is designed with a security-first approach, independently approved by leading third-party agency DEKRA. Our compliance with critical cybersecurity standards ensures you are building your network on a trusted and protected platform.

#### How we deliver

Cybersecurity approval by DEKRA and compliance with EN 18031 EU RED (Module B to be issued).

#### This means for your platform

Peace of mind that your network is built on a secure foundation, protecting you and your customers from potential threats.

### Empower innovation with charging data

Differentiate your platform by building services that go beyond basic charging. While our OCPP implementation is comprehensive, our APIs and AMQP data streams unlock advanced insights for custom integrations and smart energy solutions.

#### How we deliver

A comprehensive developer suite including APIs and AMQP streams that allow for individual charger visibility and control.

#### This means for your platform

The power to create unique, high-value services and smart energy solutions that your competition can't easily replicate.

---

### Scale without compromise

The Easee Charge Pro is fully interoperable with Easee Charge and Charge Core, giving you the flexibility to expand any new or existing site with the perfect product mix on the same proven platform. With 99% uptime demonstrated across 900,000+ chargers and a 5-year warranty, you can grow your network while ensuring uncompromising reliability and protecting your brand.

#### How we deliver

An interoperable charger platform with 99% uptime, robust hardware, and a standard 5-year product warranty.

#### This means for your platform

More flexible and reliable network solutions, ultimately strengthening your brand and increasing customer trust.

---

### Provide certified measuring



Enable your customers to deploy professional, revenue-generating charging services. The built-in MID-certified meter provides the accuracy required for public billing and automated reimbursement services across the EU/EEA. You can confidently integrate this data into your platform to offer secure and compliant payment solutions.

#### How we deliver

A fully integrated, MID-certified energy meter (Class B  $\pm 1\%$ ).

#### This means for your platform

The ability to support professional and commercial installations without requiring third-party hardware.

---

### A Future-proof partner

The charging landscape is constantly evolving, and we are committed to that future. The Easee Charge Pro is engineered to be ready for what's next. Automatic firmware updates ensure your network is always secure and evolving. With hardware built for Vehicle-to-Grid (V2G) and a clear roadmap including ISO 15118 and OCPP 2.x, partnering with Easee means providing your customers with a solution that will grow with the industry.

#### How we deliver

V2G-ready hardware, automatic Over-The-Air (OTA) updates, and a commitment to future standards like OCPP 2.x and ISO 15118.

#### This means for your platform

Increased customer confidence and a hardware solution that aligns with your long-term technology roadmap.



### Streamline operations and minimize site visits

Drastically reduce your operational costs and improve service quality. Commissioning is seamless and can be done in seconds remotely via app, portal, or API. For ongoing maintenance, our powerful remote management tools provide access to over 250 data points per charger. We resolve 97% of all service issues remotely, virtually eliminating the need for costly on-site interventions from your team or partners.

### How we deliver

The Easee Installer App for rapid commissioning and the Easee Control and Easee Fix platform for advanced remote diagnostics and maintenance.

### This means for your platform

Substantially lower overhead, faster issue resolution, and a better overall customer experience.

## Co-branding

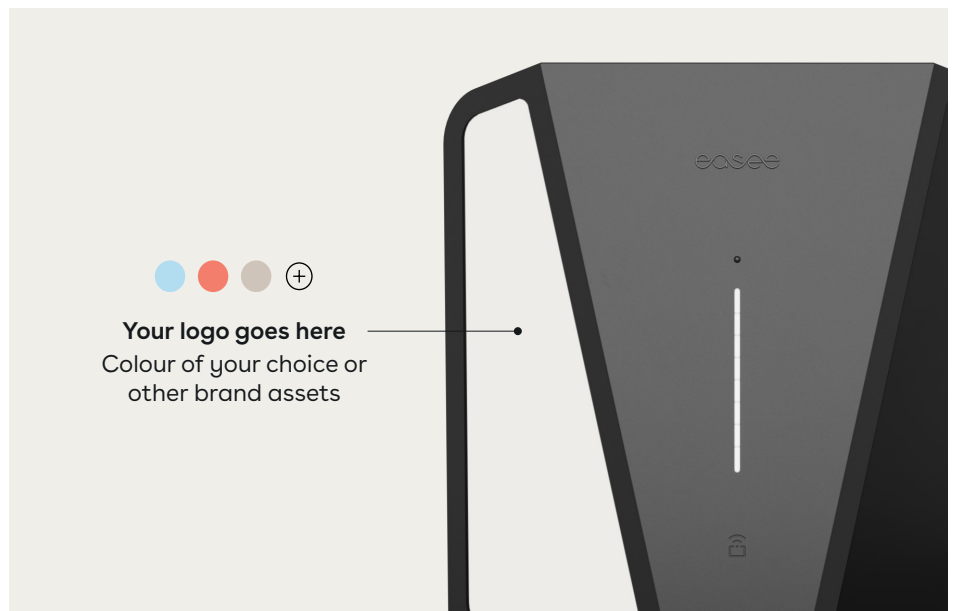

We now offer professional co-branding options for the Easee Charge Pro, allowing your logo to be featured prominently on the front cover.

Contact our commercial team at [sales@easee.com](mailto:sales@easee.com) to get started.

## Become a partner

Ready to integrate a more flexible, reliable, and future-proof hardware solution into your platform? Our team is ready to support your success.



Explore our developer documentation and APIs.

[easee.com/en/integrations](https://easee.com/en/integrations)



Contact our integrations partnership team for a technical deep-dive.  
[support.easee.com](https://support.easee.com)